

Front and Bottom Views

Back and Top Views

Alphanumeric Keypad

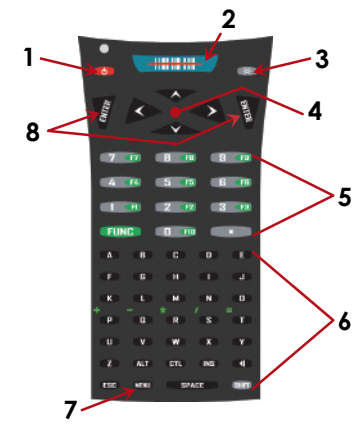
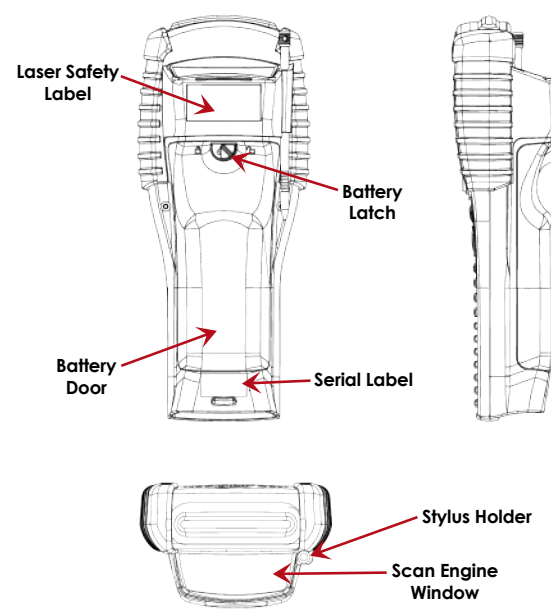
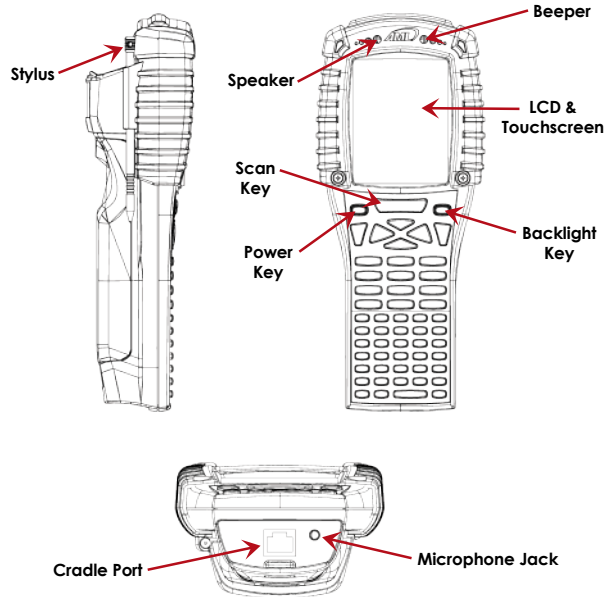

- 1. Power ON/OFF Key
- 2. Scan Key
- 3. Backlight Key
- 4. Arrow Keys
- 5. Numeric Keys
- 6. Alpha Keys
- 7. Menu Key
- 8. Enter Keys

800.648.4452
www.amltd.com
MADE IN USA
09202016-1



Getting Started

Getting Started

Getting Started

Getting Started

1 Load the main battery

2 Charge the M7225 for at least 4 hours

3 Using the Touchscreen

4 Learn More about the AML M7225

1. Turn the access latch counter-clockwise



2. Remove the battery door by hinging it upward

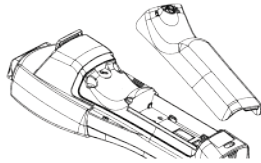

3. Insert battery in rear and slide towards the front to engage

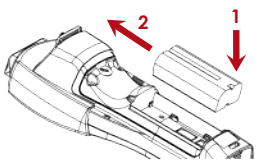

4. Turn the access latch clockwise

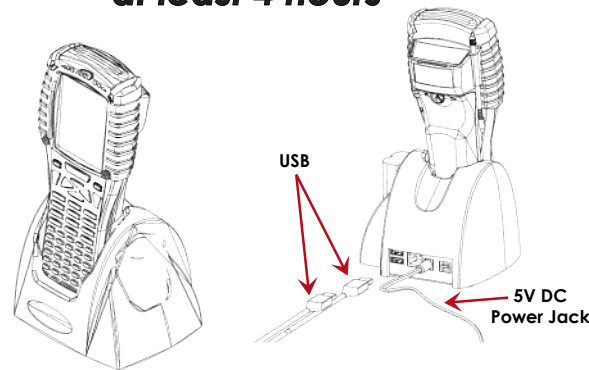

Battery Charge Times

Main Battery	Backup Battery
Before Initial Use = 4 hours	Before Initial Use = 1 hour
For Full Charge = 5 hours	For Full Charge = 2 hours

The M7225 uses a resistive-type touchscreen that can be used with gloved fingers or a plastic tipped stylus.

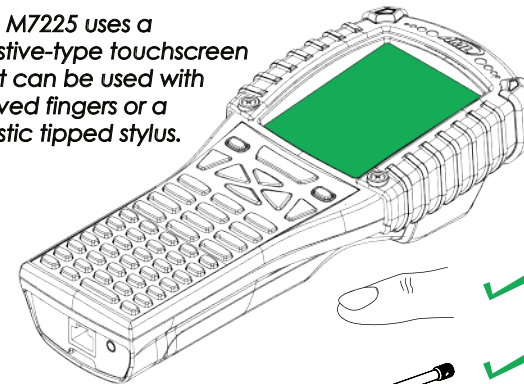

NEVER USE METAL OR SHARP OBJECTS ON THE TOUCHSCREEN!

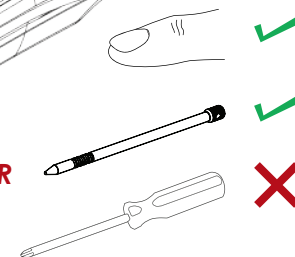

Learn more about the M7225 at:

www.amltd.com/m7225

or

Give us a call at
800.648.4452

Get Updates from AML
Don't forget to register your product(s) online at www.amltd.com/register to receive updates about AML products and software.

Using the Summit Client Utility

- 1 Open the Summit Client Utility
- 2 Enter Admin password: **SUMMIT**



Using the Summit Client Utility

- 3 From Profile Tab: Create New Profile
- 4 Configure WLAN settings: Commit
- 5 From Main Tab: Change Active Profile



Using the Wavelink Client



The M7225 comes equipped with a Wavelink Client



This icon opens the Wavelink Client



Internet Explorer

This device comes equipped with Internet Explorer



This icon opens Internet Explorer



1. Remove the battery cover and main battery.

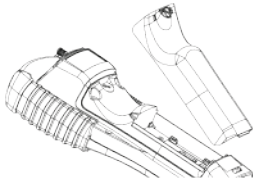

2. Locate the microSD card slot. To open the socket, slide the metal tab to the right and hinge upward.

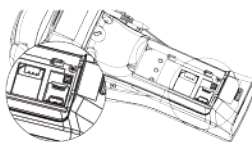

3. Insert the microSD card fully into the slot. Hinge the tab downward and slide into the locked position.

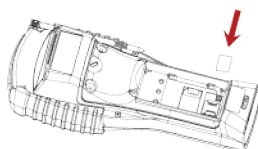

4. Turn the access latch clockwise
THE UNIT MUST BE COLD BOOTED AFTER INSERTING SD CARD!

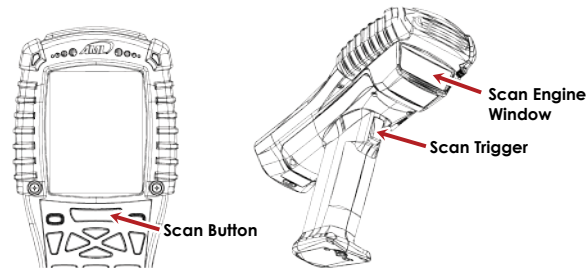

Laser - The laser scan engines require proper alignment of the bar code under the scanner window.



2D Imager - Capable of scanning bar codes at any orientation as long as the entire symbol is visible to the scanner and illuminated.



ACC-7225 Communications Cradle

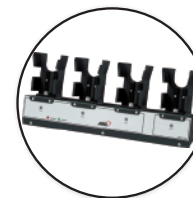

4-Position Computer or Terminal Charger



4-Position Battery Charging Cradle

© 2016 American Microsystems, Ltd. All rights reserved.

American Microsystems, Ltd. reserves the right to make changes in specifications and other information contained in this document without prior notice, and the reader should in all cases consult American Microsystems, Ltd. to determine whether any such changes have been made. The information in this publication does not represent a commitment on the part of American Microsystems, Ltd. American Microsystems, Ltd. shall not be liable for technical or editorial errors or omissions contained herein; nor for incidental or consequential damages resulting from the furnishing, performance, or use of this material. This document contains proprietary information which is protected by copyright. All rights are reserved. No part of this document may be photocopied, reproduced, or translated into another language without the prior written consent of American Microsystems, Ltd.



NOM NVCE Safety NOM/NYCE-NOM-019-SCFI-1998 Safety of data processing equipment

Warranty Agreements

SVC-EW7225 Extended Warranty, 3 year, M7225

SVC-EWP7225 Extended Warranty PLUS, 3 year, M7225

